



Installation instructions for PZ4AL- 01927-00, PZ4AL-01928-00 Under Run Protective Shield

LEXUS GX 460

Toyota Land Cruiser 150



Model Year	GX460	LC150 Diesel;	LC150 Petrol
Vehicle Code	URJ150L - GKTZKW;	KDJ15* L - G * * * YW; GRJ150L - G * * * KW	
Part Number		Steel:	PZ4AL- 01927- 00
		Aluminium:	PZ4AL- 01928- 00
 Weight		Steel:	13.49 Kg
		Aluminium:	9.81 Kg
 Installation Time			40min

A

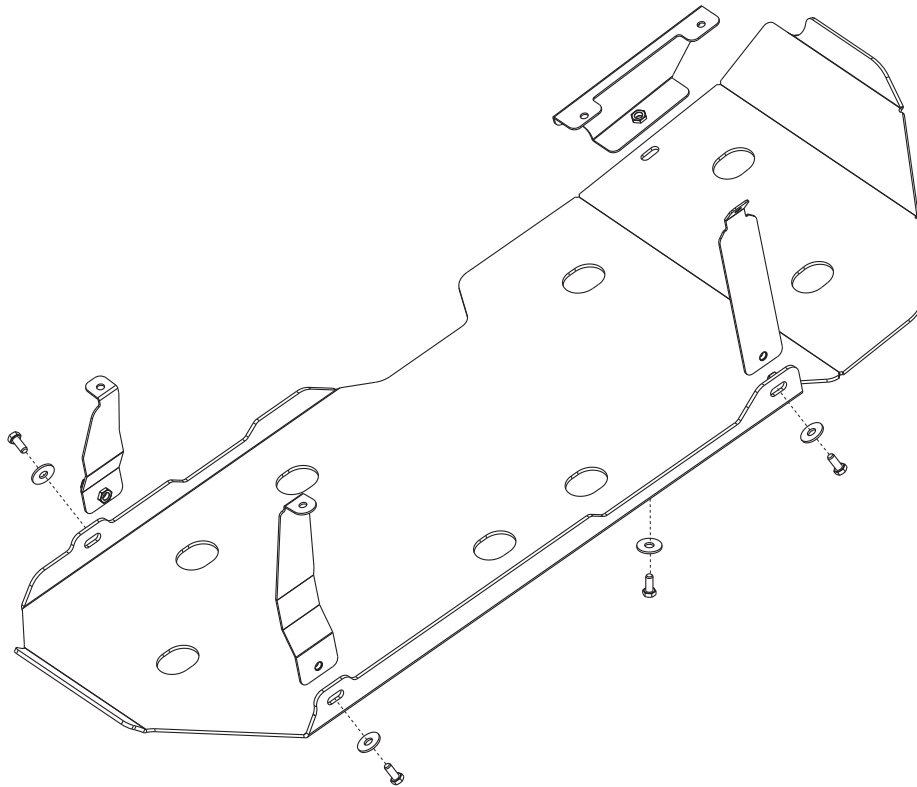

PZ4AL- 01927- 00, PZ4AL- 01928

B1



1x

B2



1x

B3

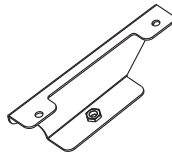

1x

B4



1x

B5

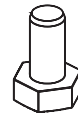

M 10x20

4x

N



Ø 10

4x

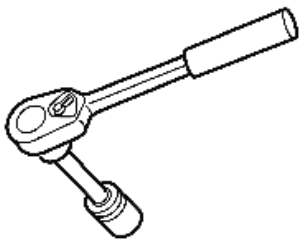

1

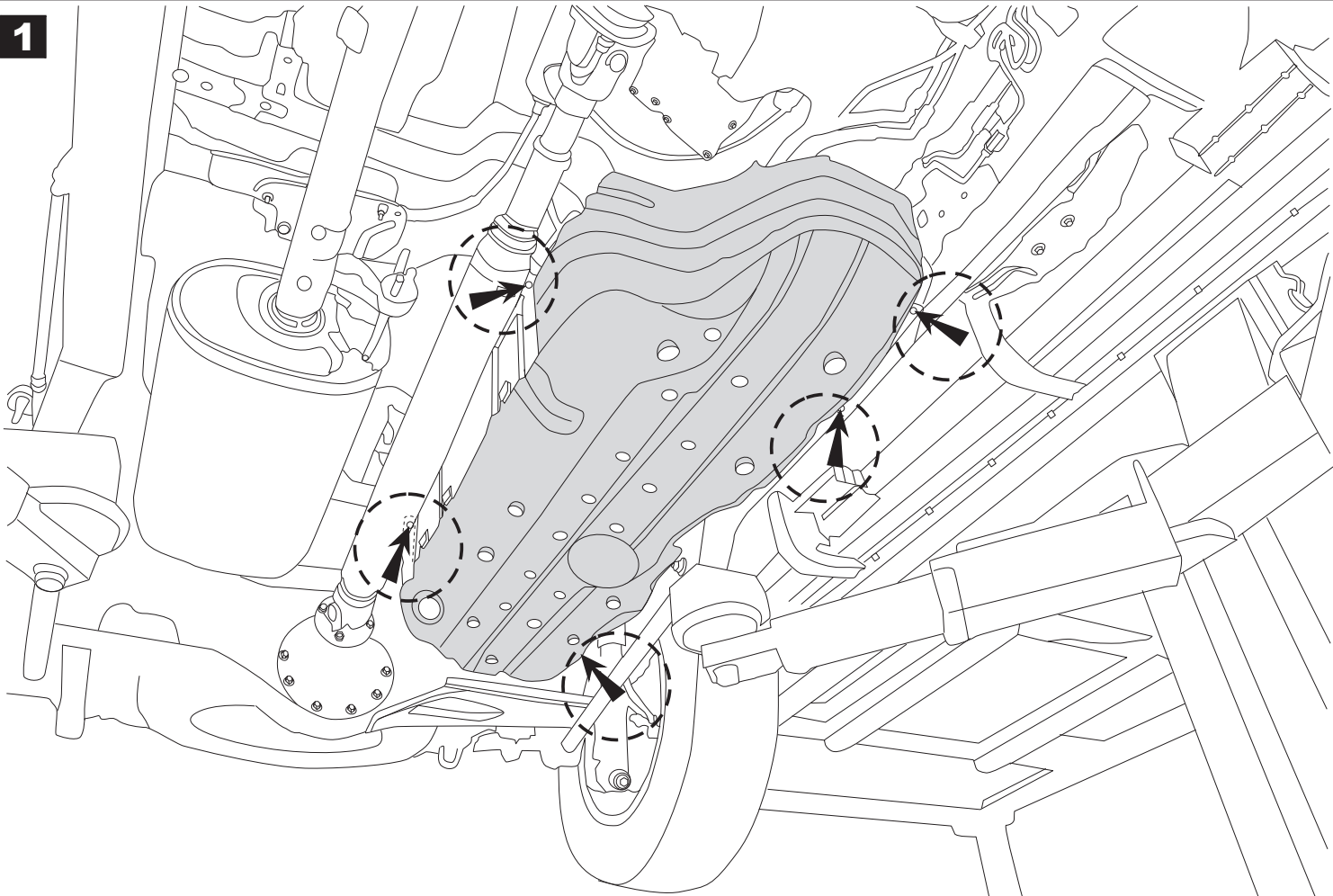

2

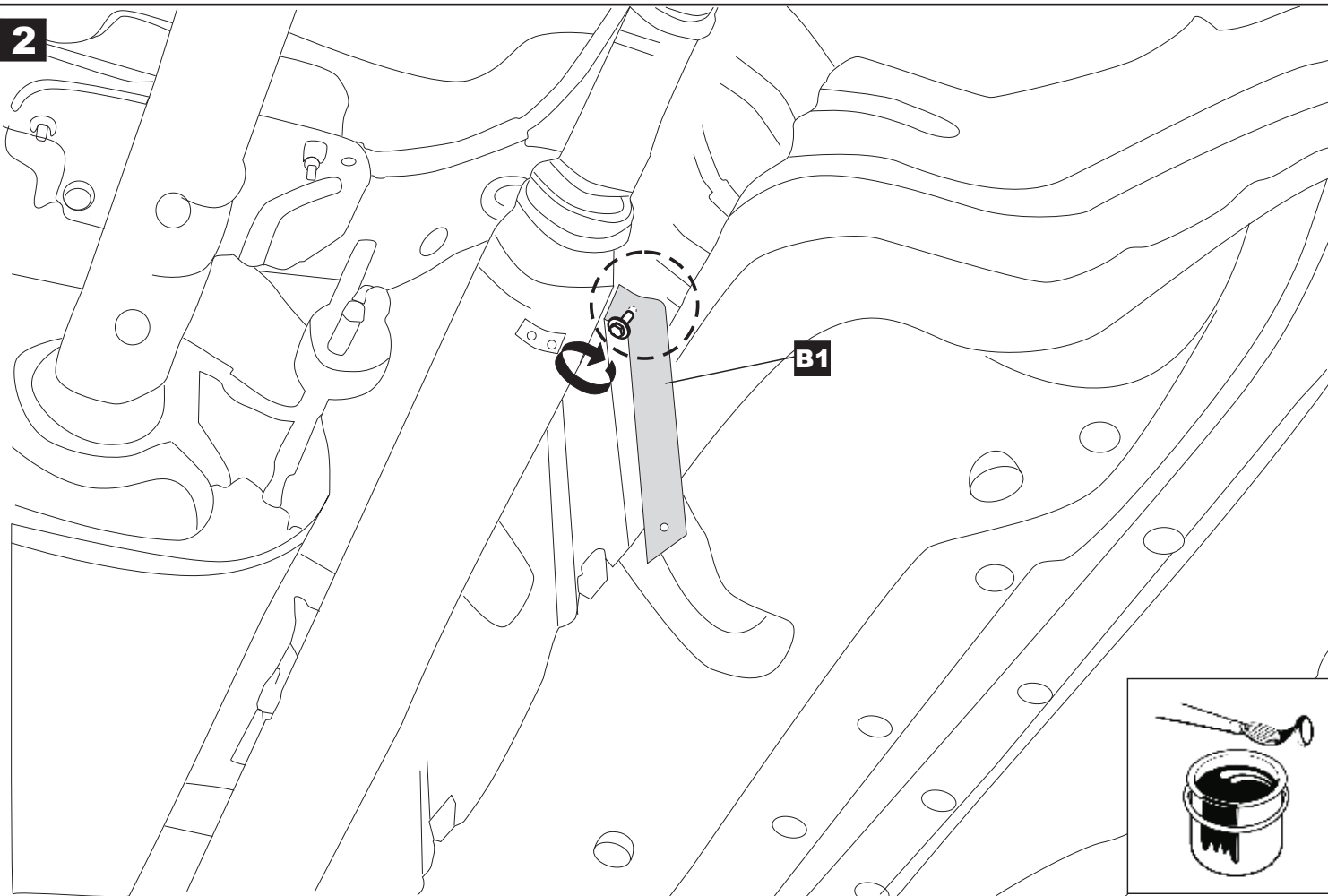

3

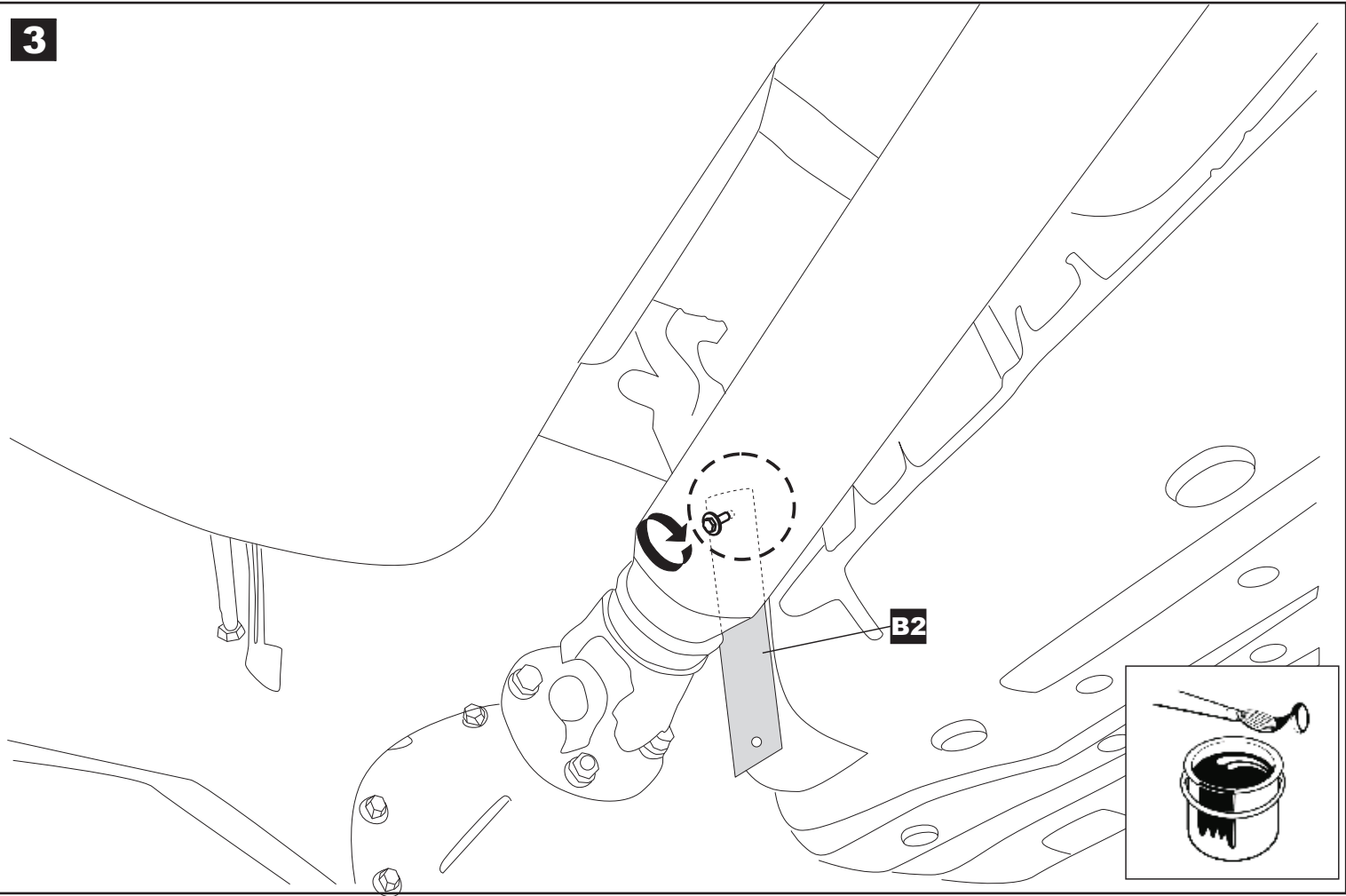

4

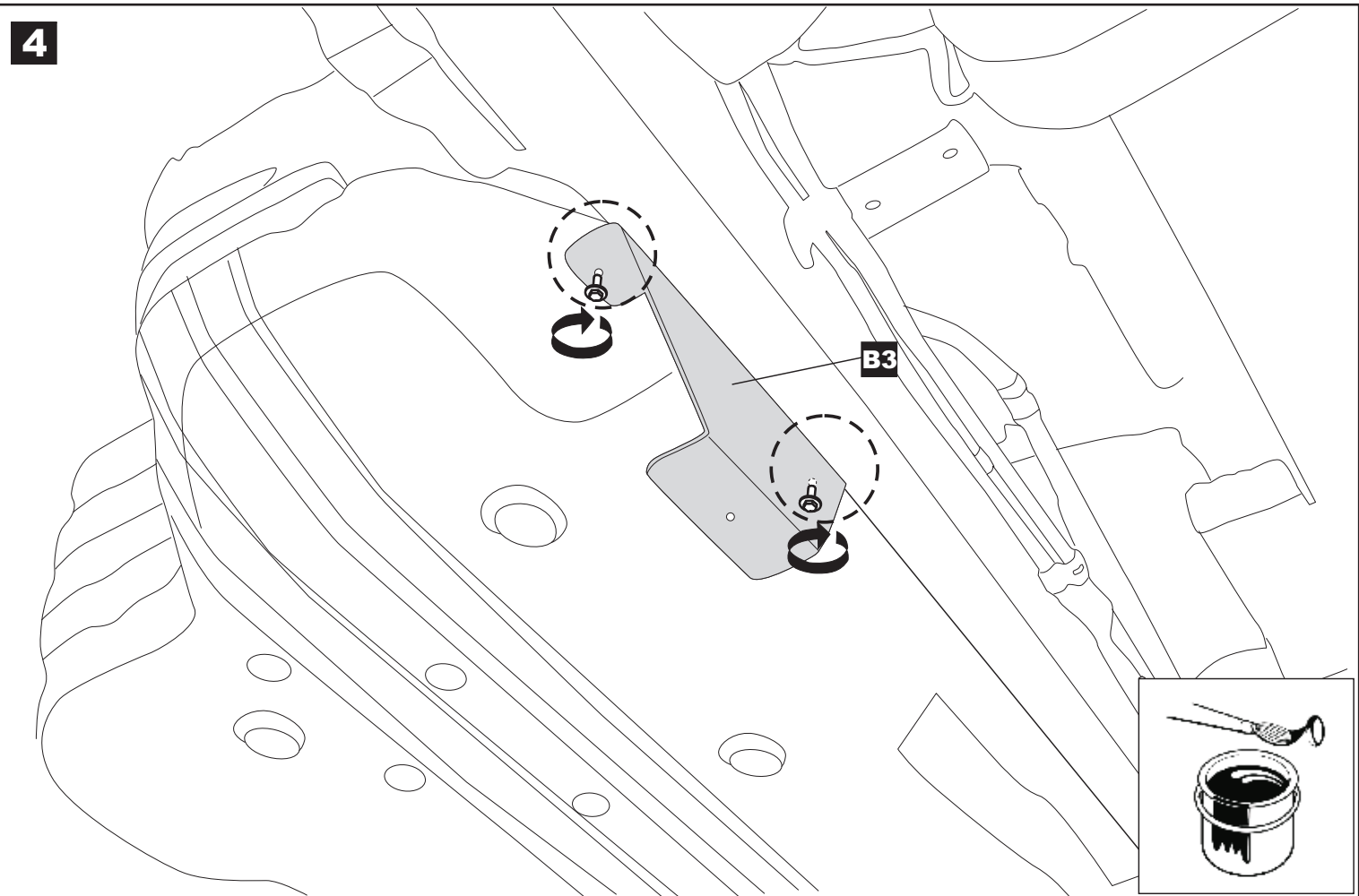

5

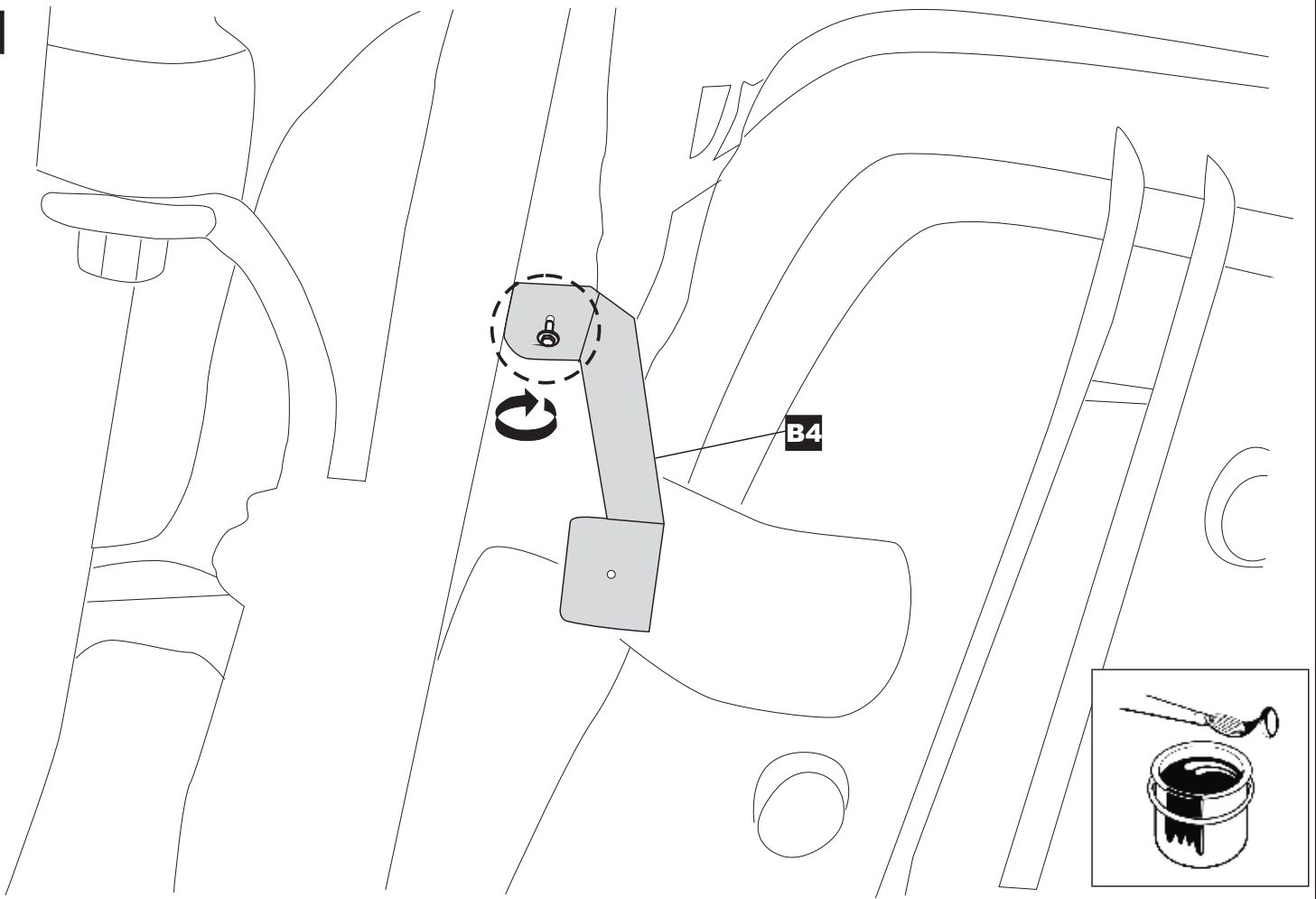

6

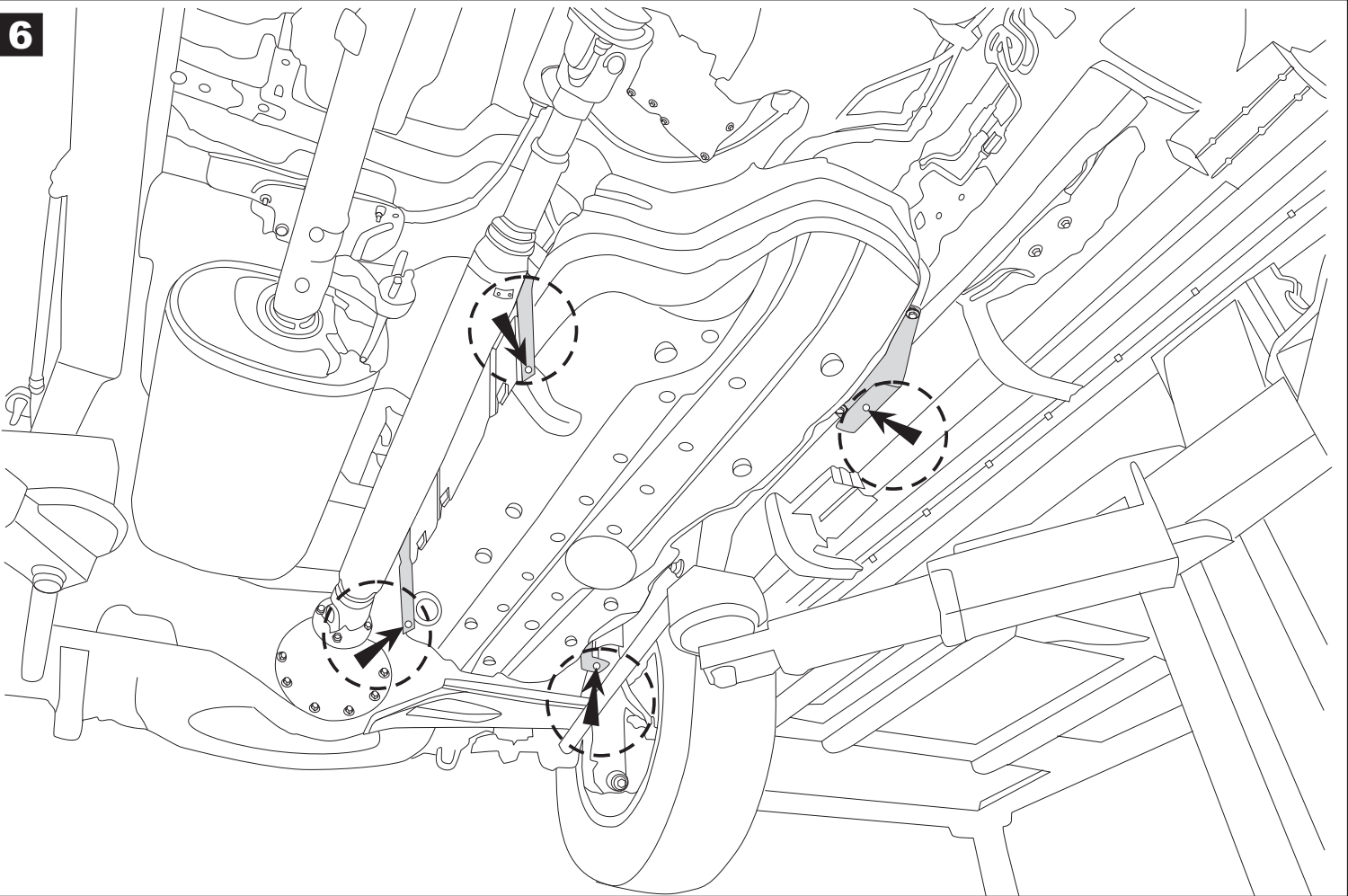

7

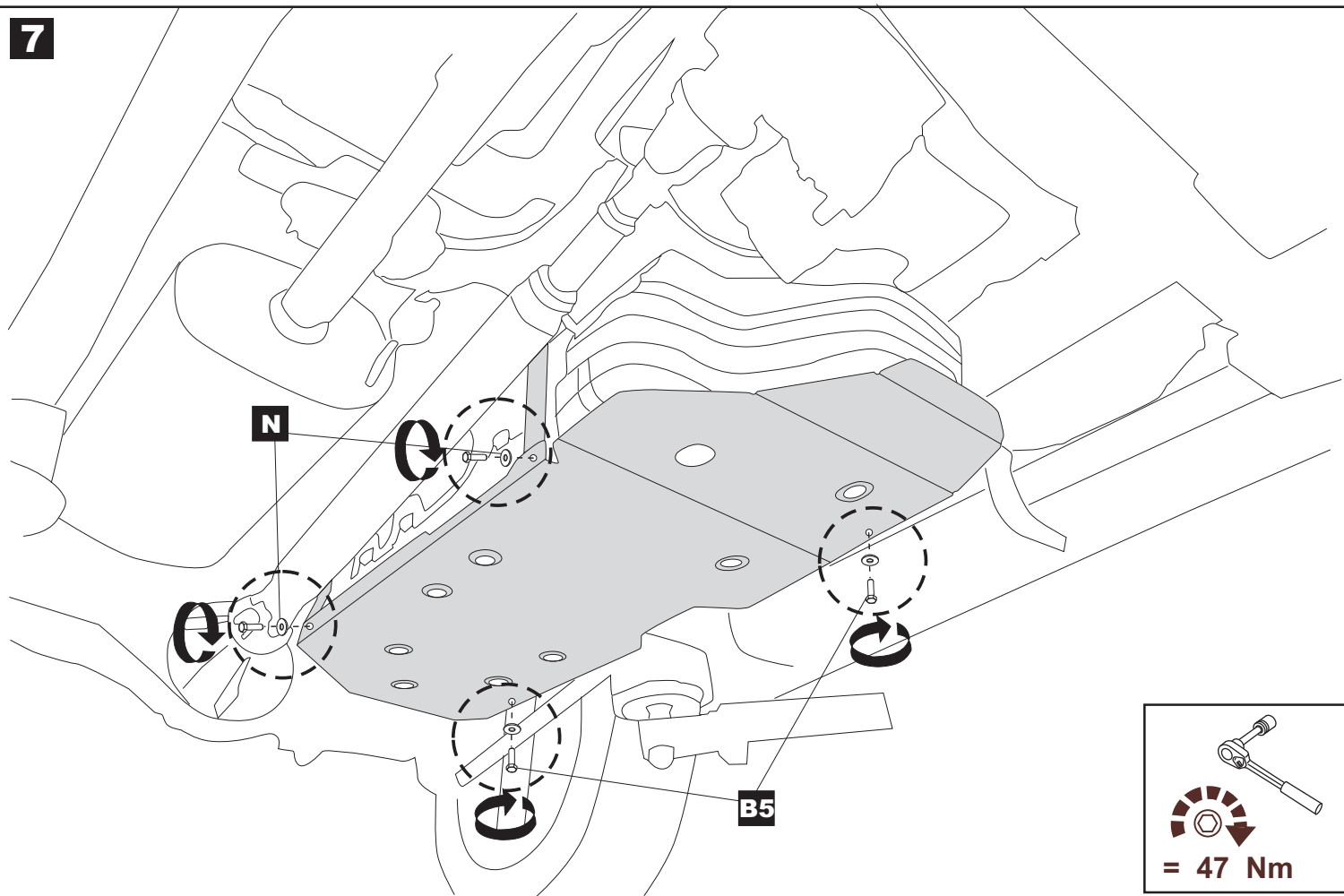

8

